

Coastal Virginia CRS Workgroup May 2021 Meeting

COASTAL VIRGINIA COMMUNITY RATING SYSTEM WORKGROUP



WORKING TOGETHER FOR A STRONGER VIRGINIA



WETLANDS
WATCH



UPDATES / ANNOUNCEMENTS

WORKGROUP MEETING INTRODUCTIONS

Zoom manners

2021 Meeting Dates (Zoom)

Wednesday, July 28, 10AM-Noon (in person & zoom - James Room)

Wednesday, September 29, 10AM-Noon (zoom only)

Wednesday, November 17, 10AM-Noon (in person & zoom - James Room)

Wednesday, January 26, 10AM-Noon (in person & zoom - James Room)

Wednesday, March 30, 10AM-Noon (in person & zoom - James Room)

Wednesday, May 25, 10AM-Noon (in person & zoom - James Room)

CFM CECs

July 2020 – 1 CEC

September 2020 – 1.5 CEC

November 2020 – 1.5 CEC

January 2021 – 1.5 CEC

March 2021 – 1.5 CEC



WETLANDS
WATCH

WWW.WETLANDSWATCH.ORG



VA FLOODPLAIN MANAGEMENT ASSOCIATION - 2021 MEMBERSHIP CALL



Individual Memberships (\$25.00)

- Networking Opportunities
- Training and Workshops
- Membership Directory
- Quarterly Newsletters

Corporate Memberships (\$150.00)

- Same access as Individual Members
- Includes 7 members (1 membership free – \$25 discount)
- Company logo on the VFMA website

[Link to membership page](#)



WETLANDS
WATCH

WWW.WETLANDSWATCH.ORG



ISO VIRGINIA REPRESENTATIVE

Emily Schmidt

ISO/CRS Specialist

emily.schmidt@verisk.com

Cannot attend today – I can pass questions along



WETLANDS
WATCH

WWW.WETLANDSWATCH.ORG



VA DCR FLOODPLAIN STAFF

New Staff

Brandy Buford

brandy.buford@dcr.virginia.gov

Michael Barber

michael.barber@dcr.virginia.gov



WETLANDS
WATCH

WWW.WETLANDSWATCH.ORG



DCR POSTED TRAININGS - [LINK FOR MORE INFO](#)

Advance Concepts: Common Noncompliance Issues & DFIRMs (5/26/21)
CFM Preparation (5/28/21)

Advance Concepts: Higher Standards in Floodplain Management (6/2/21)
CFM Preparation (6/4/21)

NFIP Best Practices (6/8/21)

CFM Preparation (6/11/21)

Advance Concepts: Disconnects Between NFIP Regs & Insurance (6/16/21)
CFM Preparation (6/18/21)

Advance Concepts: Placement of Manufactured Homes & Recreational Vehicles in
the Floodplain (6/23/21)

***DCR is facilitating and proctoring a CFM exam on June 25. Applications are due to
ASFPM by June 11th.***



WETLANDS
WATCH

WWW.WETLANDSWATCH.ORG



LOCAL CFM EXAM - SE VA

CFM Exam – Southeastern VA interest?

Ben McFarlane offering to proctor in Chesapeake



WETLANDS
WATCH

WWW.WETLANDSWATCH.ORG



BRIC - NATIONAL

Building Resilient Infrastructure Communities Fiscal Year 2020 Application Period Submissions

Number of Subapplications	Number of Structures to be Mitigated	Number of Small Impoverished Communities
991	1,521	98
Total Subapplication Costs	Federal Cost Share	Non-Federal Cost Share
\$5.50B	\$3.60B	\$1.90B

Total Subapplication Costs

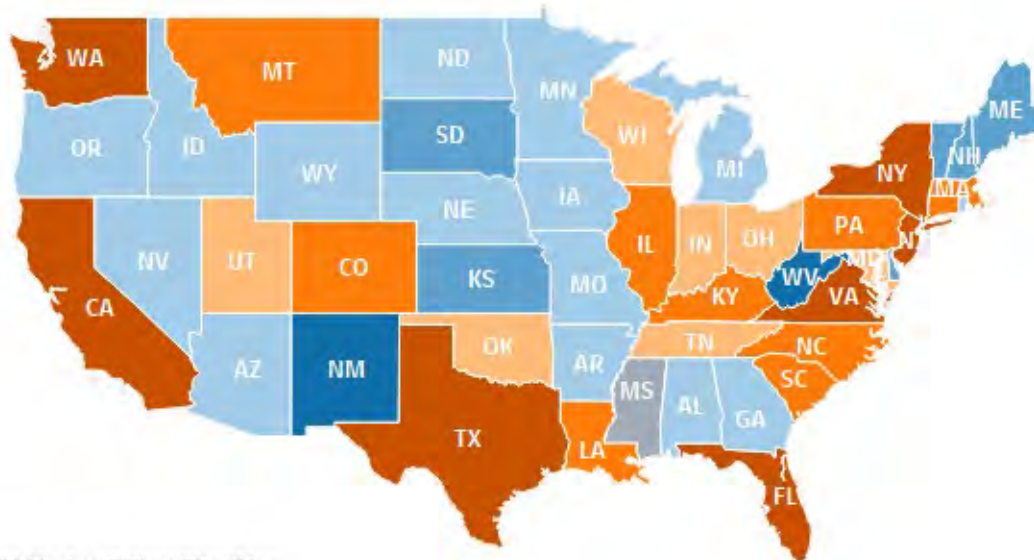

© 2021 Mapbox © OpenStreetMap



WETLANDS
WATCH

WWW.WETLANDSWATCH.ORG



BRIC - NATIONAL



WETLANDS
WATCH

WWW.WETLANDSWATCH.ORG



BRIC - VIRGINIA

Virginia

Number of Subapplications:	36
Number of Structures to be Mitigated:	36
Number of Small Impoverished Communities:	1
Total Subapplication Costs:	\$311,643,242
Federal Cost Share:	\$226,880,795
Non-Federal Cost Share:	\$84,762,447

Top 5 Subapplication Activities by Cost

Primary Activity Type	Number of Subapplications	Total Subapplication Costs
Utility and infr. protection	5	\$149,680,430
Other	3	\$74,108,846
Flood control	7	\$65,139,444
Management costs	1	\$8,840,000
Generator	5	\$5,324,352



WETLANDS
WATCH

WWW.WETLANDSWATCH.ORG



PRESENTATION: CITY OF HAMPTON BRIC APPLICATION

Scott Smith

Senior Civil Engineer/Project Manager

City of Hampton Public Works Engineering

scott.smith@Hampton.gov



WETLANDS
WATCH

WWW.WETLANDSWATCH.ORG



HAMPTON VA

2020 FEMA Building Resilient Infrastructure & Communities



Scot A. Smith, PE, LS, CPWP-M
Public Works Department

Presentation to CRS Workgroup
May 25, 2021

BRIC – Building Resiliency in Communities

Over 400 million in funding - nationally competitive process

Application period opens September 30, 2020, due to VDEM by November 9, 2020

Cap increased to 50 million per project – no limit on the number of projects submitted

75/25 matching grant – no contribution from VDEM

Community Lifelines

Definition

A lifeline enables the continuous operation of **critical business and government functions** and is essential to **human health and safety** or **economic security**.

Purpose

Root Cause Analysis

Interdependencies

Prioritization

Ease of Communication

Assessing

Status → What?

Impact → So What?

Actions → Now What?

Limiting Factors → What's the Gap?

Stabilization

Occurs when basic lifeline services or capabilities are provided to survivors (may be temporary solutions requiring sustainment).

COMPONENTS of Lifelines



BRIC Scoring Criteria

ELEMENT	POSSIBLE POINTS
Infrastructure Project?	20
Mitigates Risk to One or More Lifelines?	15
Incorporates Nature Based Solutions?	10
State has Mandatory Building Code Adoption Requirement (2015 or 2015 versions of IBC/IRC)	20
City has Building Code Effectiveness Grading Schedule Rating of 1 to 5	15
Current Application Generated from Previous Advance Assistance Award	10
Increased Non-Federal Cost Share	5
City has Designation as Small Impoverished Community	5

Building Resilient Infrastructure Communities

Fiscal Year 2020 Application Period Submissions

Number of Subapplications

991

Total Subapplication Costs

\$5.50B

Number of Structures to be Mitigated

1,521

Federal Cost Share

\$3.60B

Number of Small Impoverished Communities

98

Non-Federal Cost Share

\$1.90B

Total Subapplication Costs

- <\$1M
- \$5M - \$50M
- \$100M - \$200M
- No Submissions
- \$1M - \$5M
- \$50M - \$100M
- >\$200M

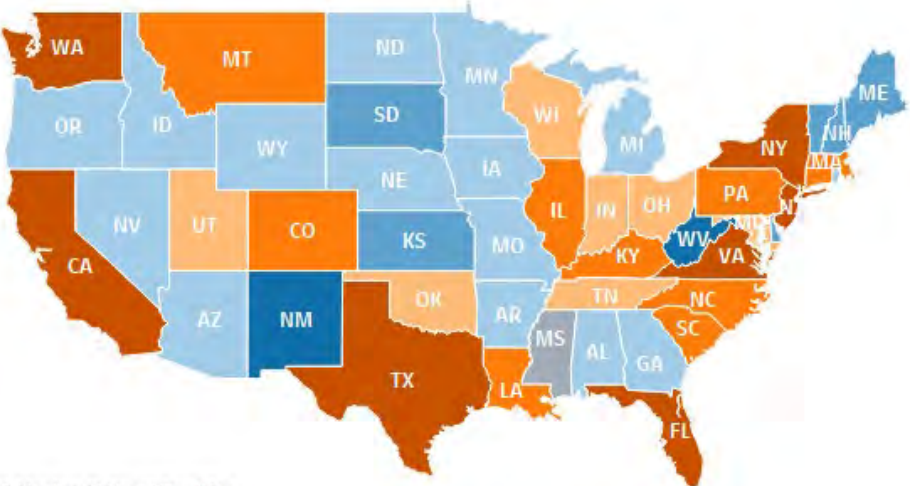

© 2021 Mapbox © OpenStreetMap

- Alaska ●
- American Samoa ●
- District of Columbia ●
- Guam ●
- Hawaii ●
- Northern Mariana Islands ●
- Puerto Rico ●
- Virgin Islands ●
- Tribal ●

Subapplication Activity by Total Subapplication Costs

Top 10



This visualization contains data from the Fiscal Year 2020 application cycle for the Building Resilient Infrastructure and Communities that closed on Jan. 29, 2021. Data Source: FEMA Grants Outcomes (GO).

PROPOSED PROJECTS

- North Armistead Resilient Road Project \$13.1M
 - Road Elevation \$4.3M
 - Green Infrastructure \$6.4M
 - Lake Hampton Upgrades \$2.4M
- Lincoln Street Corridor Stormwater Improvements \$6.0M
 - Honor Park – Green Infrastructure Park \$3.9M
 - Lincoln Street Landing Park– Green Infrastructure Park \$1.1M
 - Downtown Living Shoreline Project \$1.0M
- Pump Station – Emergency Generator/Quick Connections \$0.5M

ESTIMATED TOTAL COST: \$19,600,000

project ONE

North Armistead Avenue Flood Mitigation

*Elevation of Road Segment, Green Infrastructure,
Raise and Strengthen Earthen Berm*



Resilient Hampton Project along North Armistead Avenue between Convention Center Boulevard and LaSalle Avenue.

- Elevate the road between the Newmarket Creek Bridge and Findley Street to approximately elevation 8.
- Green Infrastructure and pedestrian improvements will be installed to help slow, store, and redirect stormwater.
- Lake Hampton to include raising and strengthening the earthen Berm adjacent to Newmarket Creek.

ESTIMATED TOTAL COST: \$13,100,000

Design Elevations

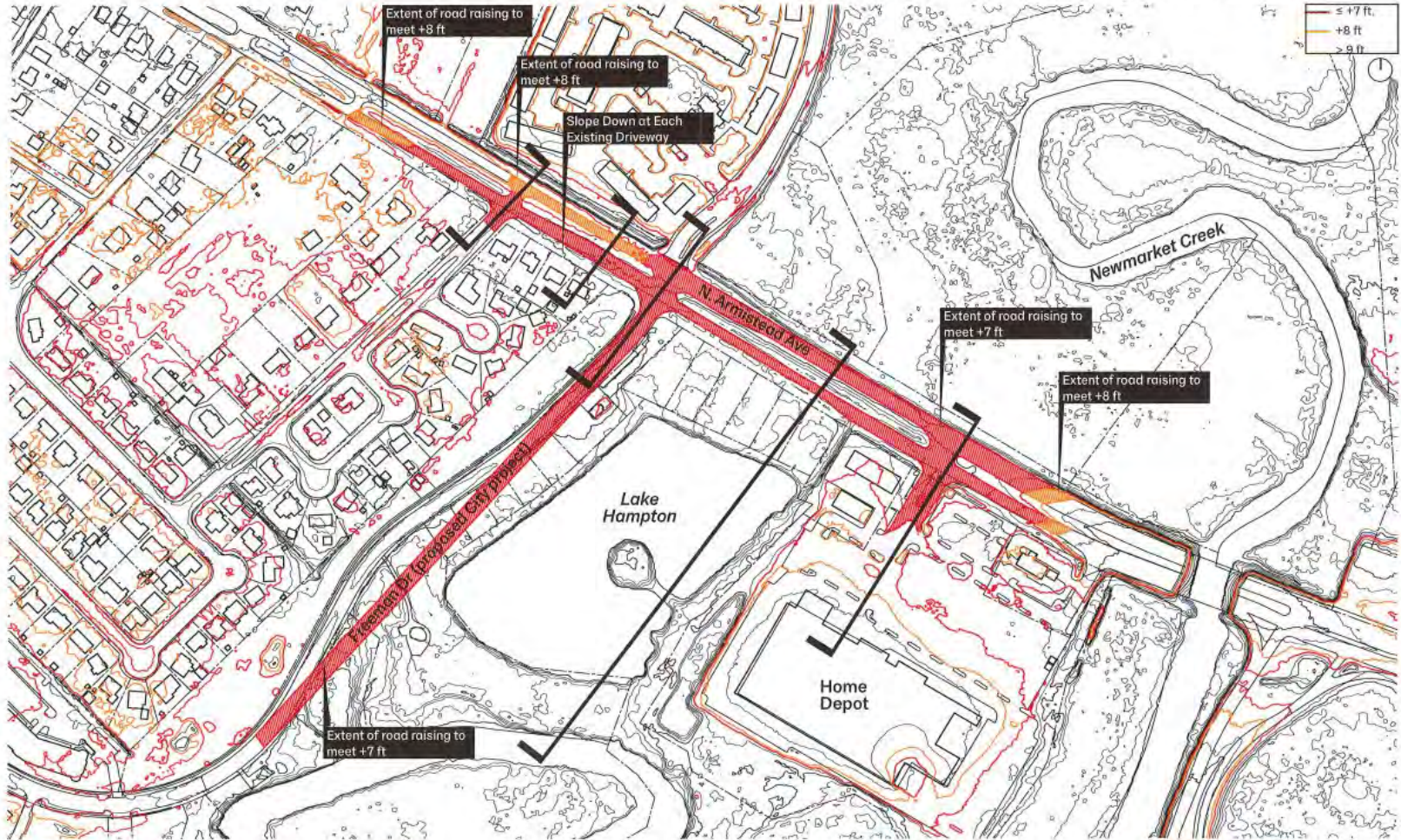



North Armistead Ave. October 29, 2012

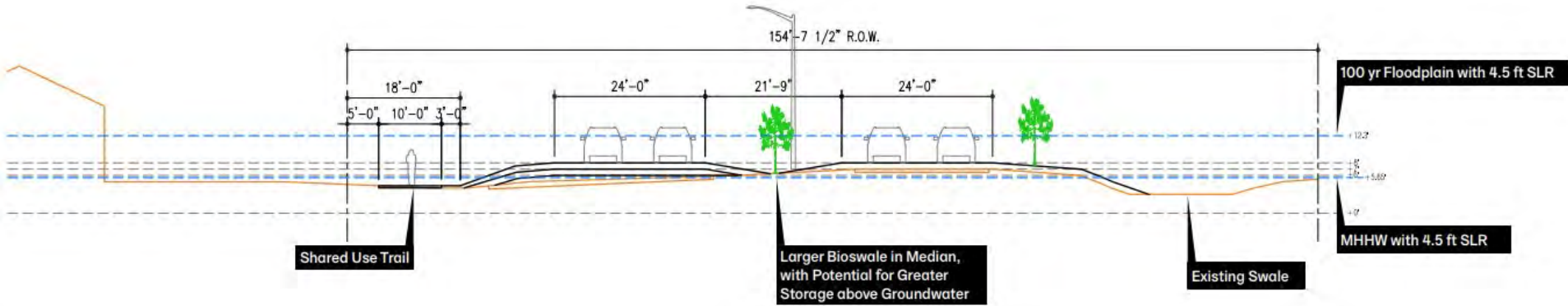

Section through N. Armistead Ave North of Freeman Dr

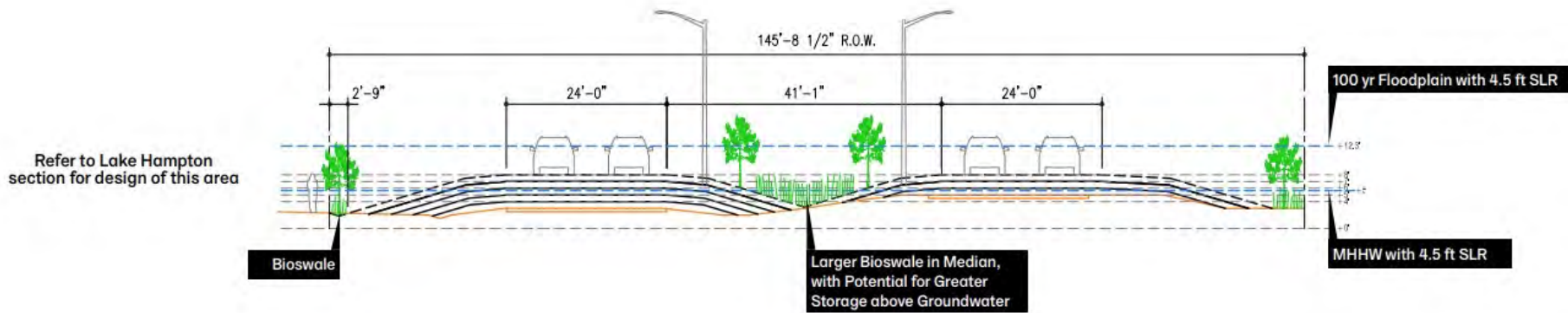



Section Perspective of N. Armistead Ave, North of Freeman Dr

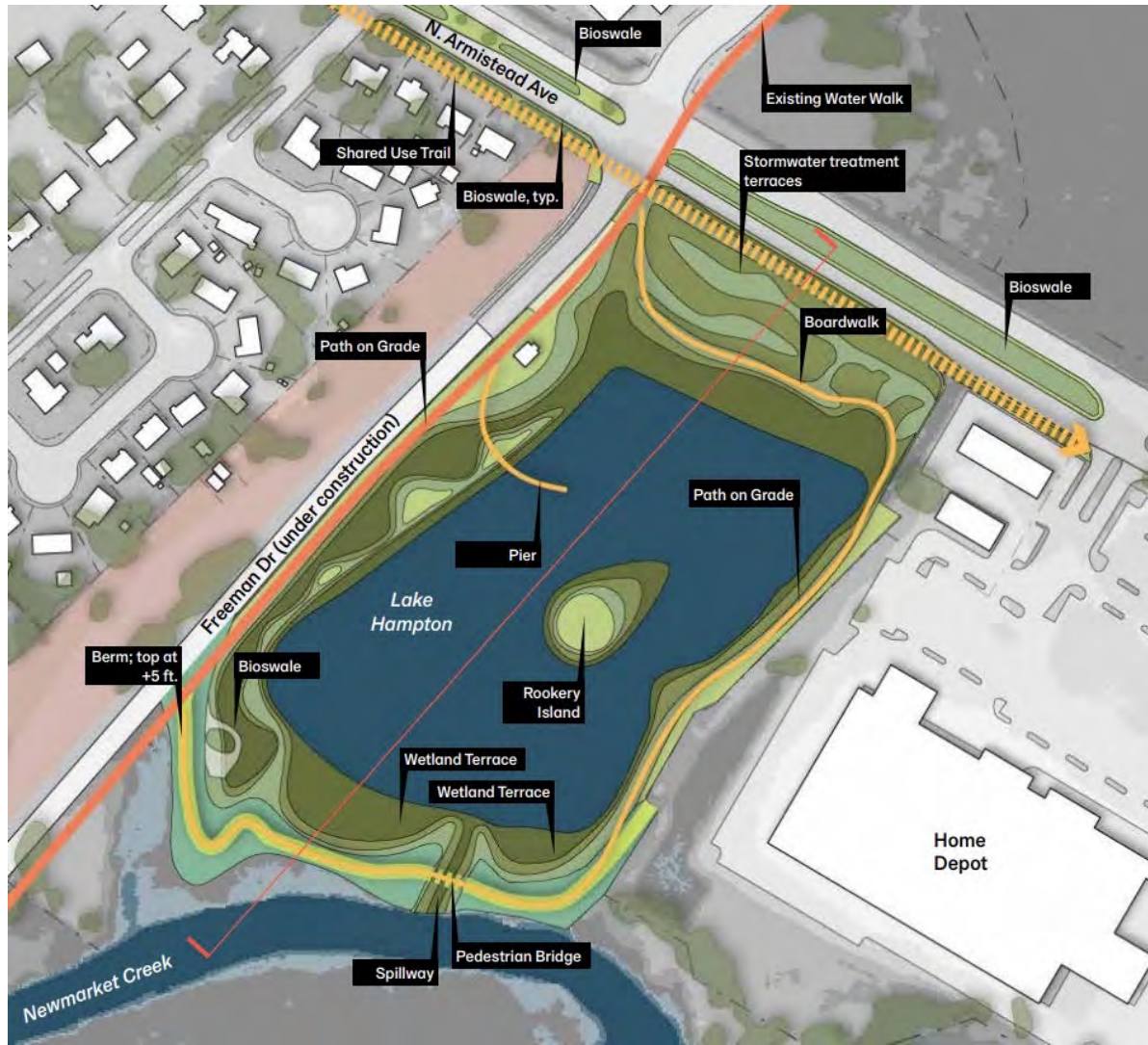

project TWO

Lincoln Street Corridor Improvements—

Nature Based drainage improvements to provide storage and shoreline stabilization

- The Honor Park project incorporates the area between the public Safety Building and City Hall. It will be a stormwater park providing storage, runoff reduction and social amenities.
- Lincoln Street Landing Park. At Lincoln Street and Eaton Street this existing parking lot will be transformed into a stormwater park providing storage, runoff reduction and social amenities.
- Downtown Living Shoreline. Create a living shoreline from the Lincoln Street Landing Park to Mill Point Park.

ESTIMATED TOTAL COST: \$6,000,000

















**A Report for the City Planners of Hampton, VA
May 4th, 2017**

Prepared by: Haley Lloyd, Andres Soria, & Isabella Young



Figure 6. Proposed Lincoln Park.



Figure 3-18 - Conceptual Rendering of the Mill Point Living Shoreline

project **THREE**

Sanitary Sewer Pump Station Stand-by Emergency Power – *Stationary Generators and Quick Connects*

Power outages from storms and other events leave mechanical systems at sanitary pump stations with no electrical power to pump when they are required to do so. If power is not restored quickly, sewage overflow is possible, with potentially devastating effects to public health and safety, beaches and sensitive wildlife areas and public road access.

ESTIMATED TOTAL COST: \$500,000



BRIC POLL

POLL!



WETLANDS
WATCH

WWW.WETLANDSWATCH.ORG



VA COMMUNITY FLOOD PREPAREDNESS FUND

- Grant manual
 - Released 4/5/21
 - Comment period closed 5/12/21
 - Effective date (TownHall) 6/1/21
 - View comments [here](#)
- Draft guidelines
 - Released 11/28/20
 - Comment period closed 1/31/21
 - View comments [here](#)
 - Agency [responses](#) issued 5/6/21



WETLANDS
WATCH

WWW.WETLANDSWATCH.ORG



VA COMMUNITY FLOOD PREPAREDNESS FUND

Types of Grants Available

- Capacity Building
- Projects
 - Must have local flood resilience plan
 - Must have CFM on staff or on hire



WETLANDS
WATCH

WWW.WETLANDSWATCH.ORG



FEMA RISK RATING 2.0

We're keeping a website up to date with new RR 2.0 information:

<https://wetlandswatch.org/federal-policy-updates>

New info coming (post ASFPM presentation)

What can policyholders with steep flood insurance costs today expect under new pricing methodology?

Methodology	Single-Family Home Maximum Policy Cost*
Current Rating Methodology	\$45,925
Risk Rating 2.0	\$12,125

Policyholders paying the most under the current methodology will see dramatic decreases when they transition to Risk Rating 2.0.

*Amounts shown include premium, fees, assessments, and surcharges.



WETLANDS
WATCH

WWW.WETLANDSWATCH.ORG



FEMA

Federal Emergency Management Agency

FEMA RISK RATING 2.0

<https://wetlandswatch.org/federal-policy-updates>

Virginia			
Monthly Change	All Policies	Single Family Home	
<-\$100	6,468	4,912	Decreases
\$-100 to \$-90	666	560	
\$-90 to \$-80	695	564	
\$-80 to \$-70	864	627	
\$-70 to \$-60	1,038	728	
\$-60 to \$-50	1,121	824	
\$-50 to \$-40	2,134	921	
\$-40 to \$-30	2,106	1,177	
\$-30 to \$-20	3,041	1,721	
\$-20 to \$-10	8,970	6,684	
<u>\$-10 to \$0</u>	<u>19,708</u>	<u>14,194</u>	
Total Green Bar	46,811	32,912	
			Slight Increases
\$0 to \$10	50,929	43,434	
			Bigger Increases
\$10 to \$20	5,093	4,094	
			Biggest Increases
\$20 to \$30	1,142	708	
\$30 to \$40	391	133	
\$40 to \$50	183	41	
\$50 to \$60	112	6	
\$60 to \$70	38	-	
\$70 to \$80	17	-	
\$80 to \$90	18	-	
\$90 to \$100	11	-	
<u>>\$100</u>	<u>36</u>	<u>-</u>	
Total Grey Bar	1,948	888	

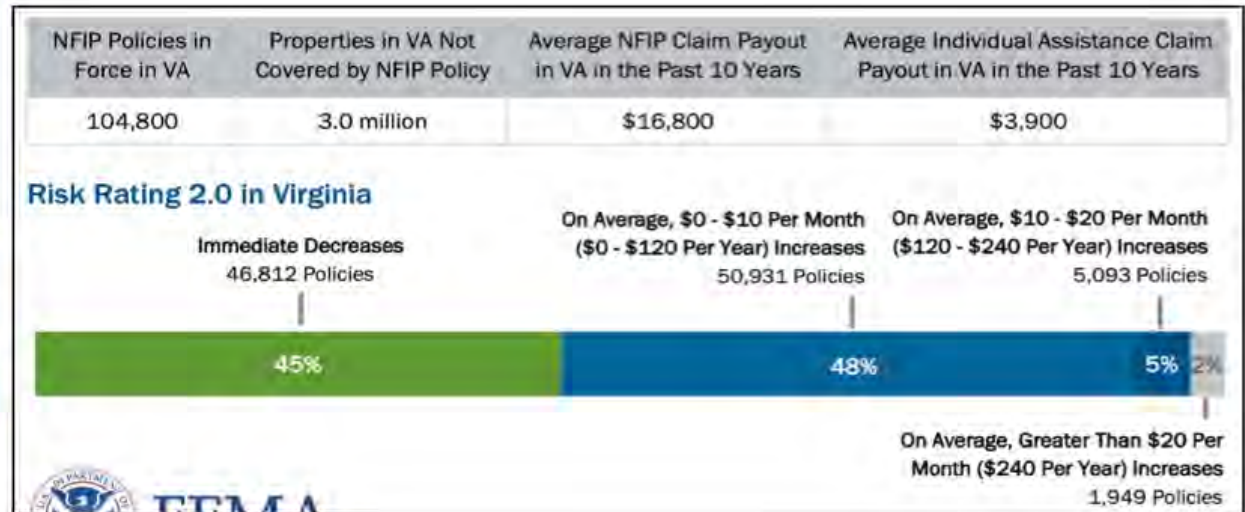

CRS TRAINING/EVALUATION

Wetlands Watch's CRS Training & Evaluation

- Poll -



WETLANDS
WATCH

WWW.WETLANDSWATCH.ORG



WORKGROUP MEMBER/ATTENDEE REPORT OUTS

Time for Workgroup members/attendees to bring up any news, questions, or future meeting topics to the group.



WETLANDS
WATCH

WWW.WETLANDSWATCH.ORG



THANKS!

Mary-Carson Stiff

Wetlands Watch

mc.stiff@wetlandswatch.org



WETLANDS
WATCH

WWW.WETLANDSWATCH.ORG

